

**PARTITION LEGEND**

WALL RATING	NFPA 101 - LIFE SAFETY CODE- 2012 EDITION
30 min.	FULLY SPRINKLERED WITH QUICK RESPONSE SPRINKLER HEADS *Corridor construction in existing facilities that are not fully sprinklered. *Walls are to extend to the structure above or a fire rated ceiling assembly. *Doors shall have a 20 minute label, resist the passage of smoke and have positive latching.
M Building Code- MBC One - Hour (Royal Oak Only)	*Opening Protectives Shall Be Self Closing Or Released Upon Activation Of Fire Alarm. *Positive Latching Doors *Gap At Door Stop Max. 1/8" *Double Doors Require Astragals If Gap Between Doors Is Greater Than 1/8" *Door Undercuts Max. 3/4" *Maximum Measurement For Doors That Are Skewed Or Out Of Plumb Is 1/2" *Michigan Building Code 1HR Fire Dampers Required In Soiled Utility Rooms & Rooms without Ceilings *3/4 Hour Door *All Penetrations Shall Be Sealed With Approved (HILTI) Fire Stopping - Floor To Deck
One - Hour NFPA	*Opening Protectives Shall Be Self Closing Or Released Upon Activation Of Fire Alarm. *Positive Latching Doors *Gap At Door Stop Max. 1/8" *Double Doors Require Astragals If Gap Between Doors Is Greater Than 1/8" *Door Undercuts Max. 3/4" *Maximum Measurement For Doors That Are Skewed Or Out Of Plumb Is 1/2" *No Fire Dampers Required *3/4 Hour Door *All Penetrations Shall Be Sealed With Approved (HILTI) Fire Stopping - Floor To Deck
Two - Hour	*Opening Protectives Shall Be Self Closing Or Released Upon Activation Of Fire Alarm. *Positive Latching Doors *Gap At Door Stop Max. 1/8" *Double Doors Require Astragals If Gap Between Doors Is Greater Than 1/8" *Door Undercuts Max. 3/4" *Maximum Measurement For Doors That Are Skewed Or Out Of Plumb Is 1/2" *Fire Dampers Required *1 1/2 Hour Door *All Penetrations Shall Be Sealed With Approved (HILTI) Fire Stopping - Floor To Deck
Two - Hour Building Separation	* Same As 2HR Fire Barrier * Can Be Used As A Horizontal Exit
Three - Hour Four - Hour	* Opening Protectives Shall Be Self Closing Or Released Upon Activation Of Fire Alarm. * Positive Latching Doors * Gap At Door Stop Max. 1/8" * Double Doors Require Astragals If Gap Between Doors Is Greater Than 1/8" * Door Undercuts Max. 3/4" * Maximum Measurement For Doors That Are Skewed Or Out Of Plumb Is 1/2" * Fire Dampers Required * 3 Hour Door * All Penetrations Shall Be Sealed With Approved (HILTI) Fire Stopping - Floor To Deck
Smoke Barrier	* Walls Built to One Hour Construction * Opening Protectives Shall Be Self Closing Or Released Upon Activation Of Fire Alarm. * Positive Latching Doors Not Required Unless in a Corridor Wall or Fire Barrier * Gap At Door Stop Max. 1/8" * Double Doors Require Astragals If Gap Between Doors Is Greater Than 1/8" * Door Undercuts Max. 3/4" * Maximum Measurement For Doors That Are Skewed Or Out Of Plumb Is 1/2" * Smoke Dampers Required (Royal Oak only) * 20 Minute Door of 1 3/4" Thick Solid Core Bonded Wood Door * No Positive Latching Required For Cross Corridor Doors * All Penetrations Shall Be Sealed With Approved (HILTI) Fire Stopping - Floor To Deck * Center Door Mullions are Prohibited
Smoke Tight Partition	* Corridor construction in fully sprinklered smoke compartment in existing facilities that are not fully sprinklered. * Smoke Tight Construction * No Door Labels- Solid Core Door Minimum * Positive Latching Doors * Door Undercuts Max. 1" * Maximum Measurement For Doors That Are Skewed Or Out Of Plumb Is 1/2" * If Ceiling & Doors are Smoke Tight Construction, Walls To Deck Not Required * If There is No Ceiling in Space, Walls to Deck Above are Required
One - Hour Smoke Zone Barrier	* Must Meet The Requirements Of The Most Stringent.
Two - Hour Smoke Zone Barrier	* Must Meet The Requirements Of The Most Stringent.
Variance Areas	* See Variance Granted By Authority Having Jurisdiction.
Change of Use	* Change of use as allowed by 2012 NFPA 101 LSC 43.7.1.2
Green Corridors	* Minimum Smoke Tight Construction * No Combustible Storage Open To Corridor * No Clear Width Obstruction Allowed
Exit Stairwells	* 4 Levels Or Less 1 Hour * 5 Levels Or More 2 Hour * Positive Latching Doors * Opening Protectives Shall Be Self Closing Doors Or Released Upon Activation of Fire Alarm System * No Storage Allowed * Only Utilities That Serve The Stair Can Run In The Stair * No Clear Width Obstruction Allowed
Connecting Stairwell	* All Penetrations In Walls & Ceiling To Be Sealed With Approved (HILTI) Fire-stopping * Penetrations In Landings Do Not Need To Be Sealed
Hatch Pattern Will Vary For Adjacent Suites	* Non-Rated Doors Do Not Require Positive Latching Within Suite * Hallways Within Suite are Not Required to be Smoke Tight * Corridor Entry Doors to Suites Require Positive Latching * Perimeter Suite Walls Adjoining Corridors Require Minimum Smoke Tight Partition Construction * Sleeping suites are noted on plans.

CHANGE OF USE LEGEND	
ROOM TYPE	REQUIREMENTS
* Storage Of Combustibles Less Than 100 s.f.	* Smoke Tight Construction (See Partition Legend) * Self Closing Doors * Doors Not Serving Corridor Do Not Need To Latch * Fire Sprinkler Protection
* Storage Of Combustibles Greater Than 100 s.f. * Soiled Linen Storage	* 1 Hr Construction (See Partition Legend) * Fire Sprinkler Protection
* Medical Gas Storage Greater Than 12-E Cylinder Or 1-Hr Cylinder Per Smoke Compartment - Does Not Include In Use Cylinders.	* Fire Sprinkler Protection * Doors Must Be Secured Against Unauthorized Entry * Oxygen And Nitrous Oxide Shall Not Be Stored With Any Flammable Gases, Liquid Or Vapor * Oxygen Or Nitrous Oxide Must Be Separated From Combustibles By 5 Ft Or Within An Enclosed Cabinet With A Minimum Fire Rating Of 1/2 Hr.
* Rack / Shelf Storage	* Minimum Distance From Sprinkler Head Or 18" With Exception Of Storage Directly Against The Wall.

**UNDER CONSTRUCTION**  
P/N: FHP\_16\_00001\_00

LAST REVISED: **6/26/2017**  
 REVISION BY: **M.J.L.**  
 SCALE: **NO SCALE**  
 TITLE: **FARMINGTON HILLS LOWER LEVEL COMPOSITE LIFE SAFETY FLOORPLAN**  
 DWG NO: **LSP-00**  
 SYSTEM DES: **FH-LIFE SAFETY**

**Note:**  
The Record Conditions Depicted Here Within This Drawing Are Based On Construction As-Built Information and Partial Field Verification. Non-employees Of William Beaumont Using This Document Are Herby Notified That William Beaumont Hospital Assumes No Liability For The Accuracy Of The Information As Shown. Using This Document In No Way Relieves The User Of Responsibility For Verification Of Actual Field Conditions.

**PARTITION LEGEND**

WALL RATING	NFPA 101 - LIFE SAFETY CODE- 2012 EDITION Rev. 5-10-17
30 min.	*Corridor construction in existing facilities that are not fully sprinklered. *Walls are to extend to the structure above or a fire rated ceiling assembly. *Doors shall have a 20 minute label, resist the passage of smoke and have positive latching. *Opening Protectives Shall Be Self Closing Or Released Upon Activation Of Fire Alarm. *Positive Latching Doors *Gap At Door Stop Max. 1/8" *Double Doors Require Astragals If Gap Between Doors is Greater Than 1/8" *Door Undercuts Max. 3/4" *Maximum Measurement For Doors That Are Skewed Or Out Of Plumb is 1/2" *Michigan Building Code 1HR Fire Dampers Required In Solved Utility Rooms & Rooms without Ceilings *3/4 Hour Door *All Penetrations Shall Be Sealed With Approved (HILTI) Fire Stopping - Floor To Deck
MI Building Code - MBC One - Hour (Royal Oak Only)	*Opening Protectives Shall Be Self Closing Or Released Upon Activation Of Fire Alarm. *Gap At Door Stop Max. 1/8" *Double Doors Require Astragals If Gap Between Doors is Greater Than 1/8" *Door Undercuts Max. 3/4" *Maximum Measurement For Doors That Are Skewed Or Out Of Plumb is 1/2" *No Fire Dampers Required *3/4 Hour Door *All Penetrations Shall Be Sealed With Approved (HILTI) Fire Stopping - Floor To Deck
One - Hour NFPA	*Opening Protectives Shall Be Self Closing Or Released Upon Activation Of Fire Alarm. *Gap At Door Stop Max. 1/8" *Double Doors Require Astragals If Gap Between Doors is Greater Than 1/8" *Door Undercuts Max. 3/4" *Maximum Measurement For Doors That Are Skewed Or Out Of Plumb is 1/2" *No Fire Dampers Required *3/4 Hour Door *All Penetrations Shall Be Sealed With Approved (HILTI) Fire Stopping - Floor To Deck
Two - Hour	*Opening Protectives Shall Be Self Closing Or Released Upon Activation Of Fire Alarm. *Positive Latching Doors *Gap At Door Stop Max. 1/8" *Double Doors Require Astragals If Gap Between Doors is Greater Than 1/8" *Door Undercuts Max. 3/4" *Maximum Measurement For Doors That Are Skewed Or Out Of Plumb is 1/2" *Fire Dampers Required *1 1/2 Hour Door *All Penetrations Shall Be Sealed With Approved (HILTI) Fire Stopping - Floor To Deck
Two - Hour Building Separation	* Same As 2HR Fire Barrier * Can Be Used As A Horizontal Exit
Three - Hour Four - Hour	*Opening Protectives Shall Be Self Closing Or Released Upon Activation Of Fire Alarm. *Gap At Door Stop Max. 1/8" *Double Doors Require Astragals If Gap Between Doors is Greater Than 1/8" *Door Undercuts Max. 3/4" *Maximum Measurement For Doors That Are Skewed Or Out Of Plumb is 1/2" *Fire Dampers Required *3 Hour Door *All Penetrations Shall Be Sealed With Approved (HILTI) Fire Stopping - Floor To Deck
Smoke Barrier	* Walls Built to One Hour Construction * Opening Protectives Shall Be Self Closing Or Released Upon Activation Of Fire Alarm. * Positive Latching Doors * Gap At Door Stop Max. 1/8" * Double Doors Require Astragals If Gap Between Doors is Greater Than 1/8" * Door Undercuts Max. 3/4" * Maximum Measurement For Doors That Are Skewed Or Out Of Plumb is 1/2" * Smoke Dampers Required (Royal Oak Only) * 20 Minute Door or 1 3/4" Thick Solid Core Bonded Wood Door * No Positive Latching Required For Cross Corridor Doors * All Penetrations Shall Be Sealed With Approved (HILTI) Fire Stopping - Floor To Deck * Center Door Mullions are Prohibited
Smoke Tight Partition	* Corridor construction in fully sprinklered smoke compartment in existing facilities that are not fully sprinklered. * Smoke Tight Construction * No Door Labels- Solid Core Door Minimum * Positive Latching Doors * Door Undercuts Max. 3/4" * Maximum Measurement For Doors That Are Skewed Or Out Of Plumb is 1/2" * If Ceiling & Doors are Smoke Tight Construction, Walls To Deck Not Required * If There is No Ceiling in Space, Walls to Deck Above are Required
One - Hour Smoke Zone Barrier	* Must Meet The Requirements Of The Most Stringent.
Two - Hour Smoke Zone Barrier	* Must Meet The Requirements Of The Most Stringent.
Variance Areas	* See Variance Granted By Authority Having Jurisdiction.
Change of Use	* Change of use as allowed by 2012 NFPA 101 LSC 43.7.1.2
Egress Corridors	* Minimum Smoke Tight Construction * No Combustible Storage Open To Corridor * No Clear Width Obstruction Allowed.
Exit Stairwells	* 4 Levels Or Less 1 Hour * 5 Levels Or More 2 Hour * Positive Latching Doors * Opening Protectives Shall Be Self Closing Doors Or Released Upon Activation Of Fire Alarm System * No Storage Allowed * Only Utilities That Serve The Stair Can Run In The Stair * No Clear Width Obstruction Allowed * All Penetrations In Walls & Ceiling To Be Sealed With Approved (HILTI) Fire-stopping * Penetrations In Landings Do Not Need To Be Sealed.
Connecting Stairwell	* Non-Rated Doors Do Not Require Positive Latching Within Suite * Hallways Within Suite are Not Required to be Smoke Tight * Corridor Entry Doors to Suite Require Positive Latching * Perimeter Suite Walls Abutting Corridors Require Minimum Smoke Tight Partition Construction * Sleeping suites are noted on plans.

**CHANGE OF USE LEGEND**

ROOM TYPE	REQUIREMENTS
* Storage Of Combustibles Less Than 100 s.f.	* Smoke Tight Construction (See Partition Legend) * Self Closing Doors * Doors Not Serving Corridor Do Not Need To Latch * Fire Sprinkler Protection
* Storage Of Combustibles Greater Than 100 s.f. * Solved Linen Storage	* 1 Hr Construction (See Partition Legend) * Fire Sprinkler Protection
* Medical Gas Storage Greater Than 12-Cylinder Or 1-H Cylinder Per Smoke Compartment - Does Not Include In Use Cylinders.	* Fire Sprinkler Protection * Doors Must Be Secured Against Unauthorized Entry * Oxygen And Nitrous Oxide Shall Not Be Stored With Any Flammable Gases, Liquid Or Vapor. * Oxygen Or Nitrous Oxide Must Be Separated From Combustibles By 5 Ft Or Within An Enclosed Cabinet With A Minimum Fire Rating Of 1/2 Hr.
* Rack / Shelf Storage	* Minimum Distance From Sprinkler Head Of 18" With Exception Of Storage Directly Against The Wall.

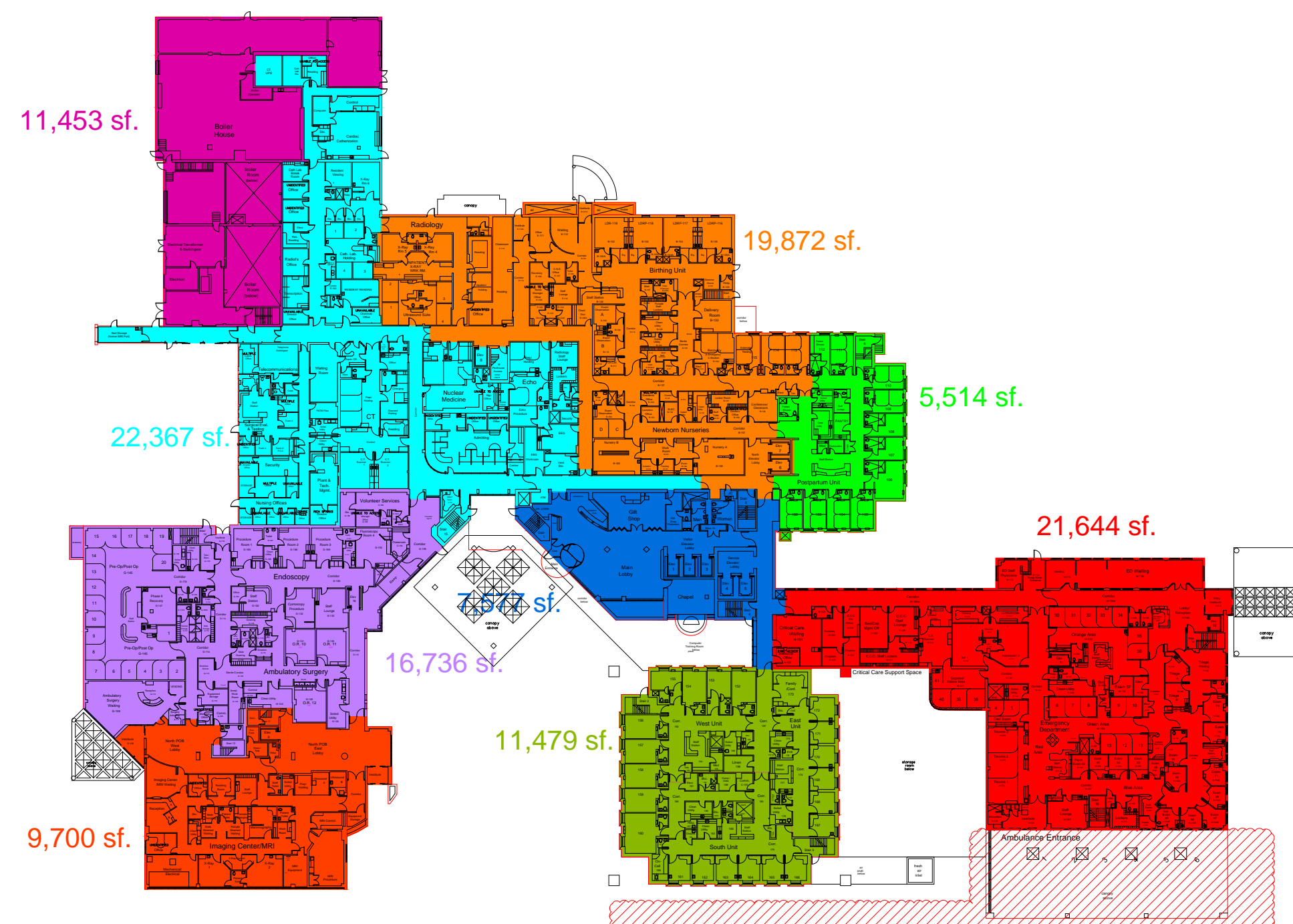

UNDER CONSTRUCTION  
P/N: FHP\_16\_00001\_00

UNDER CONSTRUCTION  
P/N: FHP\_16\_00001\_00



SUITE 5,428 Sq. Ft.

SUITE 3,648 Sq. Ft.

SUITE 287 Sq. Ft.

SUITE 939 Sq. Ft.

SUITE 1,245 Sq. Ft.

SUITE 470 Sq. Ft.

SUITE 537 Sq. Ft.

SUITE 1,055 Sq. Ft.

SUITE 2,236 Sq. Ft.

SUITE 300 Sq. Ft.

SUITE 253 Sq. Ft.

SUITE 515 Sq. Ft.

SUITE 4,021 Sq. Ft.

SUITE 6,014 Sq. Ft.

SUITE 534 Sq. Ft.

SUITE 572 Sq. Ft.

SUITE 485 Sq. Ft.

SUITE 3,478 Sq. Ft.

SUITE 1,106 Sq. Ft.

SUITE 8,283 Sq. Ft.

**Beaumont**

2850 GRAND RIVER AVE.  
FARMINGTON HILLS MI 48334  
SITE 02.517

**TECHNICAL INFORMATION & SERVICES TEAM ESSENTIAL SYSTEMS RECORD DOCUMENTS**

**Note:**  
The Record Conditions Depicted Here Within This Drawing Are Based On Construction As-Built Information and Partial Field Verification. Non-employees of William Beaumont Hospital Assume No Liability For The Accuracy Of The Information As Shown. Using This Document In No Way Relieves The User Of Responsibility For Verification Of Actual Field Conditions.

**PARTITION LEGEND**

WALL RATING	NFPA 101 - LIFE SAFETY CODE- 2012 EDITION
	FULLY SPRINKLERED WITH QUICK RESPONSE SPRINKLER HEADS
30 min	*Corridor construction in existing facilities that are not fully sprinklered. *Walls are to extend to the structure above or a fire rated ceiling assembly. *Doors shall have a 20 minute label, resist the passage of smoke and have positive latching.
M Building Code- MBC One - Hour	* Opening Protectives Shall Be Self Closing Or Released Upon Activation Of Fire Alarm. * Positive Latching Doors * Gap At Door Stop Max. 1/8" * Double Doors Require Astragals If Gap Between Doors is Greater Than 1/8" * Door Undercuts Max. 3/4" * Maximum Measurement For Doors That Are Skewed Or Out Of Plumb Is 1/2" * Michigan Building Code 1HR Fire Dampers Required In Solid Utility Rooms & Rooms without Ceilings * 3/4 Hour Door * All Penetrations Shall Be Sealed With Approved (HILTI) Fire Stopping - Floor To Deck
One - Hour NFPA	* Opening Protectives Shall Be Self Closing Or Released Upon Activation Of Fire Alarm. * Positive Latching Doors * Gap At Door Stop Max. 1/8" * Double Doors Require Astragals If Gap Between Doors is Greater Than 1/8" * Door Undercuts Max. 3/4" * Maximum Measurement For Doors That Are Skewed Or Out Of Plumb Is 1/2" * No Fire Dampers Required * 3/4 Hour Door * All Penetrations Shall Be Sealed With Approved (HILTI) Fire Stopping - Floor To Deck
Two - Hour	* Opening Protectives Shall Be Self Closing Or Released Upon Activation Of Fire Alarm. * Positive Latching Doors * Gap At Door Stop Max. 1/8" * Double Doors Require Astragals If Gap Between Doors is Greater Than 1/8" * Door Undercuts Max. 3/4" * Maximum Measurement For Doors That Are Skewed Or Out Of Plumb Is 1/2" * Fire Dampers Required * 1 1/2 Hour Door * All Penetrations Shall Be Sealed With Approved (HILTI) Fire Stopping - Floor To Deck
Two - Hour Building Separation	* Same As 2HR Fire Barrier * Can Be Used As A Horizontal Exit
Three - Hour Four - Hour	* Opening Protectives Shall Be Self Closing Or Released Upon Activation Of Fire Alarm. * Positive Latching Doors * Gap At Door Stop Max. 1/8" * Double Doors Require Astragals If Gap Between Doors is Greater Than 1/8" * Door Undercuts Max. 3/4" * Maximum Measurement For Doors That Are Skewed Or Out Of Plumb Is 1/2" * Fire Dampers Required * 3 Hour Door * All Penetrations Shall Be Sealed With Approved (HILTI) Fire Stopping - Floor To Deck
Smoke Barrier	* Walls Built to One Hour Construction * Opening Protectives Shall Be Self Closing Or Released Upon Activation Of Fire Alarm. * Positive Latching Doors Not Required Unless in a Corridor Wall or Fire Barrier * Gap At Door Stop Max. 1/8" * Double Doors Require Astragals If Gap Between Doors is Greater Than 1/8" * Door Undercuts Max. 3/4" * Maximum Measurement For Doors That Are Skewed Or Out Of Plumb Is 1/2" * Smoke Dampers Required (Royal Oak only) * 20 Minute Door or 1 3/4" Thick Solid Core Bonded Wood Door * No Positive Latching Required For Cross Corridor Doors * All Penetrations Shall Be Sealed With Approved (HILTI) Fire Stopping - Floor To Deck * Center Door Mullions are Prohibited
Smoke Tight Partition	*Corridor construction in fully sprinklered smoke compartment in existing facilities that are not fully sprinklered. * Smoke Tight Construction * No Door Labels- Solid Core Door Minimum * Positive Latching Doors * Door Undercuts Max. 1" * Maximum Measurement For Doors That Are Skewed Or Out Of Plumb Is 1/2" * If Ceiling & Doors are Smoke Tight Construction, Walls To Deck Not Required * If There is No Ceiling in Space, Walls To Deck Above are Required
One - Hour	* Must Meet The Requirements Of The Most Stringent.
Smoke Zone Barrier	* Must Meet The Requirements Of The Most Stringent.
Two - Hour	* Must Meet The Requirements Of The Most Stringent.
Smoke Zone Barrier	* Must Meet The Requirements Of The Most Stringent.
Variance Areas	* See Variance Granted By Authority Having Jurisdiction.
Change of Use	* Change of use as allowed by 2012 NFPA 101 LSC 43.7.1.2
Egress Corridors	* Minimum Smoke Tight Construction * No Combustible Storage Open To Corridor * No Clear Width Obstruction Allowed.
Exit Stairwells	* 4 Levels Or Less 1 Hour * 5 Levels Or More 2 Hour * Positive Latching Doors * Opening Protectives Shall Be Self Closing Doors Or Released Upon Activation of Fire Alarm System * No Storage Allowed * Only Utilities That Serve The Stair Can Run In The Stair * No Clear Width Obstruction Allowed * All Penetrations in Walls & Ceiling To Be Sealed With Approved (HILTI) Fire-stopping * Penetrations in Landings Do Not Need To Be Sealed.
Connecting Stairwell	* Non-Rated Doors Do Not Require Positive Latching Within Suite * Hallways Within Suite are Not Required to be Smoke Tight * Corridor Entry Doors to Suite Require Positive Latching * Perimeter Suite Walls Abutting Corridors Require Minimum Smoke Tight Partition Construction * Sleeping suites are noted on plans.

**UNDER CONSTRUCTION**  
P/N: FHP\_16\_00001\_00

ROOM TYPE	REQUIREMENTS
* Storage Of Combustibles Less Than 100 s.f.	* Smoke Tight Construction (See Partition Legend) * Self Closing Doors * Doors Not Serving Corridor Do Not Need To Latch * Fire Sprinkler Protection
* Storage Of Combustibles Greater Than 100 s.f. * Spilled Linen Storage	* 1 Hr Construction (See Partition Legend) * Fire Sprinkler Protection
* Medical Gas Storage Greater Than 12-E Cylinder Or 1-4 Cylinder Per Smoke Compartment - Does Not Include In Use Cylinders.	* Fire Sprinkler Protection * Doors Must Be Secured Against Unauthorized Entry. * Oxygen And Nitrous Oxide Shall Not Be Stored With Any Flammable Gases, Liquid Or Vapor. * Oxygen Or Nitrous Oxide Must Be Separated From Combustibles By 5 Ft Or Within An Enclosed Cabinet With A Minimum Fire Rating Of 1/2 Hr.
* Rack / Shelf Storage	* Minimum Distance From Sprinkler Head Of 18" With Exception Of Storage Directly Against The Wall.

LAST REVISION: **6/26/2017**  
 REVISION BY: **M.J.L.**  
 SCALE: **NO SCALE**  
 TITLE: **FARMINGTON HILLS SECOND LEVEL COMPOSITE LIFE SAFETY FLOORPLAN**  
 DWG NO: **LSP-02**  
 SYSTEM DES: **FH-LIFE SAFETY**

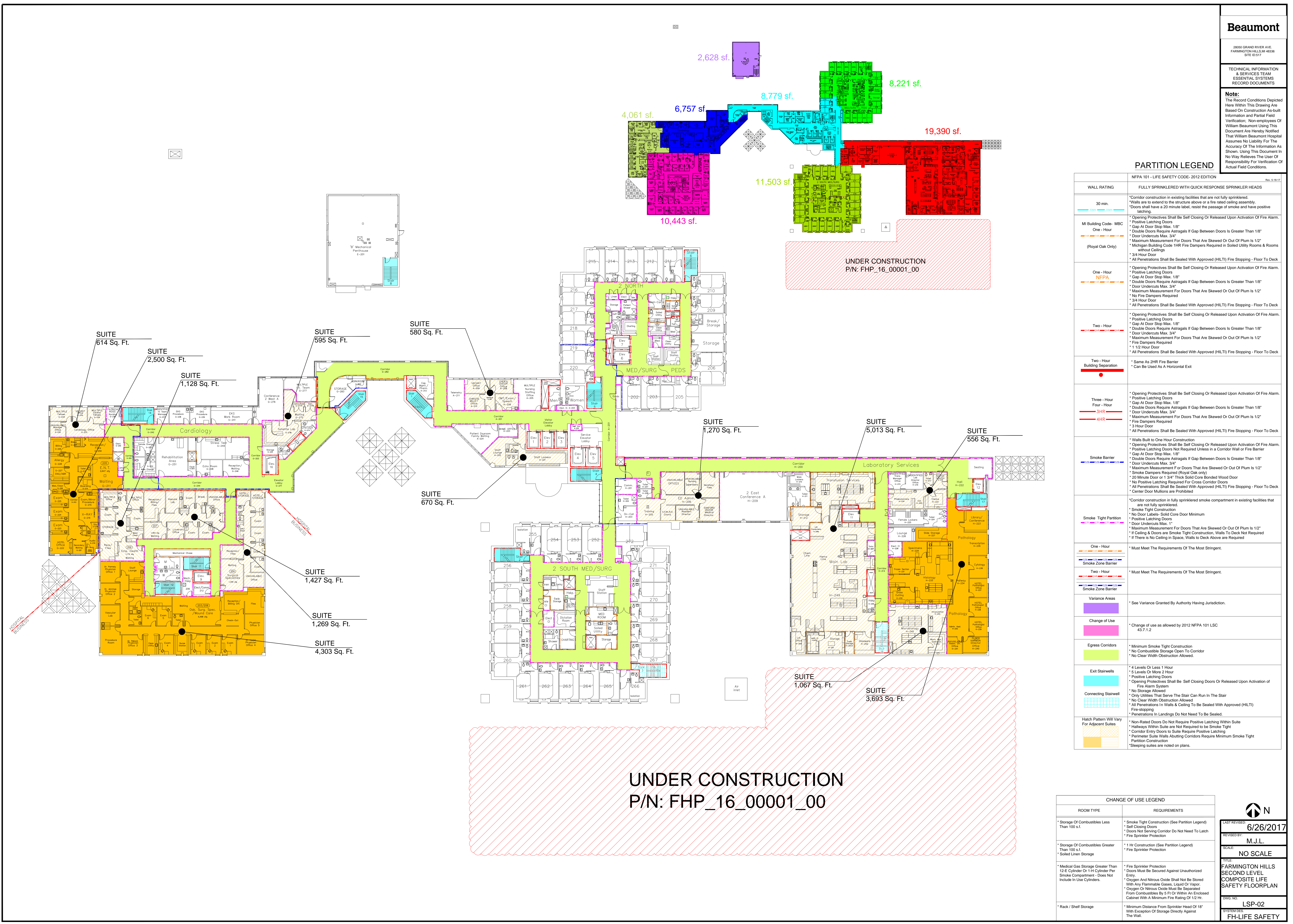

**Beaumont**

2800 GRAND RIVER AVE.  
FARMINGTON HILLS, MI 48334  
SITE 0317

TECHNICAL INFORMATION  
& SERVICES TEAM  
ESSENTIAL SYSTEMS  
RECORD DOCUMENTS

**Note:**  
The Record Conditions Depicted Here Within This Drawing Are Based On Construction As-Built Information and Partial Field Verification. Non-employees Of William Beaumont Using This Document Are Herely Notified That William Beaumont Hospital Assumes No Liability For The Accuracy Of The Information As Shown. Using This Document In No Way Relieves The User Of Responsibility For Verification Of Actual Field Conditions.

**PARTITION LEGEND**

WALL RATING	NFPA 101 - LIFE SAFETY CODE- 2012 EDITION Rev. 5-18-17
FULLY SPRINKLERED WITH QUICK RESPONSE SPRINKLER HEADS	
30 min	*Corridor construction in existing facilities that are not fully sprinklered. *Walls are to extend to the structure above or a fire rated ceiling assembly. *Doors shall have a 20 minute label, resist the passage of smoke and have positive latching.
MI Building Code- MBC One - Hour (Royal Oak Only)	* Opening Protectives Shall Be Self Closing Or Released Upon Activation Of Fire Alarm. * Positive Latching Doors * Gap At Door Step Max. 1/8" * Double Doors Require Astragals If Gap Between Doors is Greater Than 1/8" * Door Undercuts Max. 3/4" * Maximum Measurement For Doors That Are Skewed Or Out Of Plumb Is 1/2" * Michigan Building Code 1HR Fire Dampers Required In Soiled Utility Rooms & Rooms without Ceilings * 3/4 Hour Door * All Penetrations Shall Be Sealed With Approved (HLTI) Fire Stopping - Floor To Deck
One - Hour NFPA	* Opening Protectives Shall Be Self Closing Or Released Upon Activation Of Fire Alarm. * Positive Latching Doors * Gap At Door Step Max. 1/8" * Double Doors Require Astragals If Gap Between Doors is Greater Than 1/8" * Door Undercuts Max. 3/4" * Maximum Measurement For Doors That Are Skewed Or Out Of Plumb Is 1/2" * No Fire Dampers Required * 3/4 Hour Door * All Penetrations Shall Be Sealed With Approved (HLTI) Fire Stopping - Floor To Deck
Two - Hour	* Opening Protectives Shall Be Self Closing Or Released Upon Activation Of Fire Alarm. * Positive Latching Doors * Gap At Door Step Max. 1/8" * Double Doors Require Astragals If Gap Between Doors is Greater Than 1/8" * Door Undercuts Max. 3/4" * Maximum Measurement For Doors That Are Skewed Or Out Of Plumb Is 1/2" * Fire Dampers Required * 1 1/2 Hour Door * All Penetrations Shall Be Sealed With Approved (HLTI) Fire Stopping - Floor To Deck
Two - Hour Building Separation	* Same As 2HR Fire Barrier * Can Be Used As A Horizontal Ext
Three - Hour Four - Hour 3HR 4HR	* Opening Protectives Shall Be Self Closing Or Released Upon Activation Of Fire Alarm. * Positive Latching Doors * Gap At Door Step Max. 1/8" * Double Doors Require Astragals If Gap Between Doors is Greater Than 1/8" * Door Undercuts Max. 3/4" * Maximum Measurement For Doors That Are Skewed Or Out Of Plumb Is 1/2" * Fire Dampers Required * 3 Hour Door * All Penetrations Shall Be Sealed With Approved (HLTI) Fire Stopping - Floor To Deck
Smoke Barrier	* Walls Built to One Hour Construction * Opening Protectives Shall Be Self Closing Or Released Upon Activation Of Fire Alarm. * Positive Latching Doors Not Required Unless in a Corridor Wall or Fire Barrier * Gap At Door Step Max. 1/8" * Double Doors Require Astragals If Gap Between Doors is Greater Than 1/8" * Door Undercuts Max. 3/4" * Maximum Measurement For Doors That Are Skewed Or Out Of Plumb Is 1/2" * Smoke Dampers Required (Royal Oak only) * 20 Minute Door or 1 3/4" Thick Solid Core Bonded Wood Door * No Positive Latching Required For Cross Corridor Doors * All Penetrations Shall Be Sealed With Approved (HLTI) Fire Stopping - Floor To Deck * Center Door Mullions are Prohibited
Smoke Tight Partition	*Corridor construction in fully sprinklered smoke compartment in existing facilities that are not fully sprinklered. * Smoke Tight Construction * No Door Labels- Solid Core Door Minimum * Positive Latching Doors * Door Undercuts Max. 1" * Maximum Measurement For Doors That Are Skewed Or Out Of Plumb Is 1/2" * If Ceiling & Doors are Smoke Tight Construction, Walls To Deck Not Required * If There is No Ceiling in Space, Walls to Deck above are Required
One - Hour Smoke Zone Barrier	* Must Meet The Requirements Of The Most Stringent.
Two - Hour Smoke Zone Barrier	* Must Meet The Requirements Of The Most Stringent.
Variance Areas	* See Variance Granted By Authority Having Jurisdiction.
Change of Use	* Change of use as allowed by 2012 NFPA 101 LSC 43.7.1.2
Egress Corridors	* Minimum Smoke Tight Construction * No Combustible Storage Open To Corridor * No Clear Width Construction Allowed
Exit Stairwells	* 4 Levels Or Less 1 Hour * 5 Levels Or More 2 Hour * Positive Latching Doors * Opening Protectives Shall Be Self Closing Doors Or Released Upon Activation of Fire Alarm System * Only Utilities That Serve The Stair Can Run In The Stair * No Clear Width Obstruction Allowed * All Penetrations In Walls & Ceiling To Be Sealed With Approved (HLTI) Fire-stopping * Penetrations In Landings Do Not Need To Be Sealed.
Connecting Stairwell	
Hatch Pattern Will Vary For Adjacent Suites	* Non-Rated Doors Do Not Require Positive Latching Within Suite * Hallways Within Suite are Not Required to be Smoke Tight * Corridor Entry Doors to Suite Require Positive Latching * Perimeter Suite Walls Abutting Corridors Require Minimum Smoke Tight Partition Construction * Sleeping suites are noted on plans.

**UNDER CONSTRUCTION**  
P/N: FHP\_16\_00001\_00

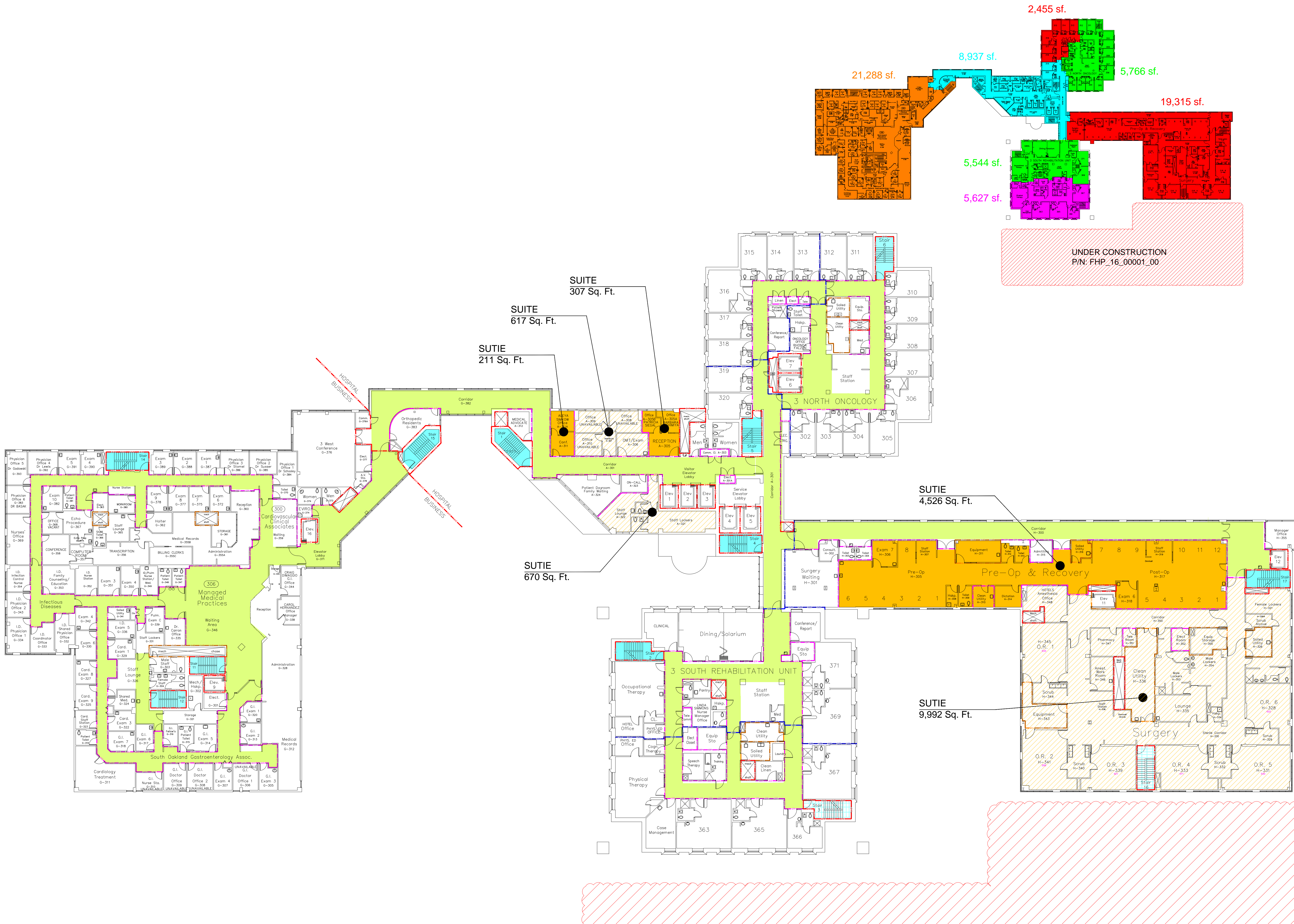

ROOM TYPE	REQUIREMENTS
* Storage Of Combustibles Less Than 100 s.f.	* Smoke Tight Construction (See Partition Legend) * Self Closing Doors * Doors Not Serving Corridor Do Not Need To Latch * Fire Sprinkler Protection
* Storage Of Combustibles Greater Than 100 s.f. * Soiled Linen Storage	* 1 Hr Construction (See Partition Legend) * Fire Sprinkler Protection
* Medical Gas Storage Greater Than 12-E Cylinder Or 1-H Cylinder Per Smoke Compartment - Does Not Include In Use Cylinders.	* Fire Sprinkler Protection * Doors Must Be Secured Against Unauthorized Entry * Oxygen And Nitrous Oxide Shall Not Be Stored With Any Flammable Gases, Liquid Or Vapor * Oxygen Or Nitrous Oxide Must Be Separated From Combustibles By 5 Ft Or Within An Enclosed Cabinet With A Minimum Fire Rating Of 1/2 Hr.
* Rack / Shelf Storage	* Minimum Distance From Sprinkler Head Of 18" The Wall. * With Exception Of Storage Directly Against The Wall.

LAST REVIEWED: **6/26/2017**

REVISION BY: **M.J.L.**

SCALE: **NO SCALE**

TITLE: **FARMINGTON HILLS THIRD LEVEL COMPOSITE LIFE SAFETY FLOORPLAN**

SYNO. NO: **LSP-03**

SYSTEM DES: **FH-LIFE SAFETY**

**Note:**  
The Record Conditions Depicted Here Within This Drawing Are Based On Construction As-built Information and Partial Field Verification. Non-employees Of William Beaumont Using This Document Are Hereby Notified That William Beaumont Hospital Assumes No Liability For The Accuracy Of The Information As Shown. Using This Document In No Way Relieves The User Of Responsibility For Verification Of Actual Field Conditions.

**PARTITION LEGEND**

NFPA 101 - LIFE SAFETY CODE- 2012 EDITION <span style="float: right;">Rev. 5-18-17</span>	
<b>WALL RATING</b>	FULLY SPRINKLERED WITH QUICK RESPONSE SPRINKLER HEADS
30 min SCMIN	*Corridor construction in existing facilities that are not fully sprinklered. *Walls are to extend to the structure above or a fire rated ceiling assembly. *Doors shall have a 20 minute label, resist the passage of smoke and have positive latching.
MI Building Code- MBC One - Hour 1HR (Royal Oak Only)	* Opening Protectives Shall Be Self Closing Or Released Upon Activation Of Fire Alarm. * Positive Latching Doors * Gap At Door Stop Max. 1/8" * Double Doors Require Astragals If Gap Between Doors is Greater Than 1/8" * Door Undercuts Max. 3/4" * Maximum Measurement For Doors That Are Skewed Or Out Of Plumb Is 1/2" * Michigan Building Code 1HR Fire Dampers Required In Soiled Utility Rooms & Rooms without Ceilings * 3/4 Hour Door * All Penetrations Shall Be Sealed With Approved (HLTI) Fire Stopping - Floor To Deck
One - Hour NFPA 1HR	* Opening Protectives Shall Be Self Closing Or Released Upon Activation Of Fire Alarm. * Positive Latching Doors * Gap At Door Stop Max. 1/8" * Double Doors Require Astragals If Gap Between Doors is Greater Than 1/8" * Door Undercuts Max. 3/4" * Maximum Measurement For Doors That Are Skewed Or Out Of Plumb Is 1/2" * No Fire Dampers Required * 3/4 Hour Door * All Penetrations Shall Be Sealed With Approved (HLTI) Fire Stopping - Floor To Deck
Two - Hour 2HR	* Opening Protectives Shall Be Self Closing Or Released Upon Activation Of Fire Alarm. * Positive Latching Doors * Gap At Door Stop Max. 1/8" * Double Doors Require Astragals If Gap Between Doors is Greater Than 1/8" * Door Undercuts Max. 3/4" * Maximum Measurement For Doors That Are Skewed Or Out Of Plumb Is 1/2" * Fire Dampers Required * 1 1/2 Hour Door * All Penetrations Shall Be Sealed With Approved (HLTI) Fire Stopping - Floor To Deck
Two - Hour Building Separation	* Same As 2HR Fire Barrier * Can Be Used As A Horizontal Exit
Three - Hour Four - Hour 3HR 4HR	* Opening Protectives Shall Be Self Closing Or Released Upon Activation Of Fire Alarm. * Positive Latching Doors * Gap At Door Stop Max. 1/8" * Double Doors Require Astragals If Gap Between Doors is Greater Than 1/8" * Door Undercuts Max. 3/4" * Maximum Measurement For Doors That Are Skewed Or Out Of Plumb Is 1/2" * Fire Dampers Required * 3 Hour Door * All Penetrations Shall Be Sealed With Approved (HLTI) Fire Stopping - Floor To Deck
Smoke Barrier SZB	* Walls Built to One Hour Construction * Opening Protectives Shall Be Self Closing Or Released Upon Activation Of Fire Alarm. * Positive Latching Doors Not Required Unless in a Corridor Wall or Fire Barrier * Gap At Door Stop Max. 1/8" * Double Doors Require Astragals If Gap Between Doors is Greater Than 1/8" * Door Undercuts Max. 3/4" * Maximum Measurement For Doors That Are Skewed Or Out Of Plumb Is 1/2" * Smoke Dampers Required (Royal Oak only) * 20 Minute Door or 1 3/4" Thick Solid Core Bonded Wood Door * No Positive Latching Required For Cross Corridor Doors * All Penetrations Shall Be Sealed With Approved (HLTI) Fire Stopping - Floor To Deck * Center Door Mullions are Prohibited
Smoke Tight Partition	* Corridor construction in fully sprinklered smoke compartment in existing facilities that are not fully sprinklered. * Smoke Tight Construction * No Door Labels- Solid Core Door Minimum * Positive Latching Doors * Door Undercuts Max. 1" * Maximum Measurement For Doors That Are Skewed Or Out Of Plumb Is 1/2" * If Ceiling & Doors are Smoke Tight Construction, Walls To Deck Not Required * If There is No Ceiling in Space, Walls to Deck Above are Required
One - Hour 1HR Smoke Zone Barrier SZB	* Must Meet The Requirements Of The Most Stringent.
Two - Hour 2HR Smoke Zone Barrier SZB	* Must Meet The Requirements Of The Most Stringent.
Variance Areas	* See Variance Granted by Authority Having Jurisdiction.
Change of Use	* Change of use as allowed by 2012 NFPA 101 LSC 43.7.1.2
Egress Corridors	* Minimum Smoke Tight Construction * No Combustible Storage Open To Corridor * No Clear Width Obstruction Allowed.
Exit Stairwells	* 4 Levels Or Less 1 Hour * 5 Levels Or More 2 Hour * Positive Latching Doors * Opening Protectives Shall Be Self Closing Doors Or Released Upon Activation of Fire Alarm System
Connecting Stairwell	* No Storage Allowed * Only Utilities That Serve The Stair Can Run In The Stair * No Clear Width Obstruction Allowed * All Penetrations In Walls & Ceiling To Be Sealed With Approved (HLTI) Fire-stopping * Penetrations In Landings Do Not Need To Be Sealed.
Hatch Pattern Will Vary For Adjacent Suites	* Non-Rated Doors Do Not Require Positive Latching Within Suite * Hallways Within Suite are Not Required to be Smoke Tight * Corridor Entry Doors to Suite Require Positive Latching * Perimeter Suite Walls Abutting Corridors Require Minimum Smoke Tight Partition Construction * Sleeping suites are noted on plans.

CHANGE OF USE LEGEND	
ROOM TYPE	REQUIREMENTS
* Storage Of Combustibles Less Than 100 s.f.	* Smoke Tight Construction (See Partition Legend) * Self Closing Doors * Doors Not Serving Corridor Do Not Need To Latch * Fire Sprinkler Protection
* Storage Of Combustibles Greater Than 100 s.f. * Soiled Linen Storage	* 1 Hr Construction (See Partition Legend) * Fire Sprinkler Protection
* Medical Gas Storage Greater Than 12-E Cylinder Or 1-H Cylinder Per Smoke Compartment - Does Not Include In Use Cylinders.	* Fire Sprinkler Protection * Doors Must Be Secured Against Unauthorized Entry * Oxygen And Nitrous Oxide Shall Not Be Stored With Any Flammable Gases, Liquid Or Vapor. * Oxygen Or Nitrous Oxide Must Be Separated From Combustibles By 5 Ft Or Within An Enclosed Cabinet With A Minimum Fire Rating Of 1/2 Hr.
* Rack / Shelf Storage	* Minimum Distance From Sprinkler Head Of 18" With Exception Of Storage Directly Against The Wall.

LAST REVISED: **6/26/2017**  
 REVISED BY: **M.J.L.**  
 SCALE: **NO SCALE**  
 TITLE: **FARMINGTON HILLS  
FOURTH LEVEL  
COMPOSITE LIFE  
SAFETY FLOORPLAN**  
 DWG. NO.: **LSP-04**  
 SYSTEMS: **FH-LIFE SAFETY**

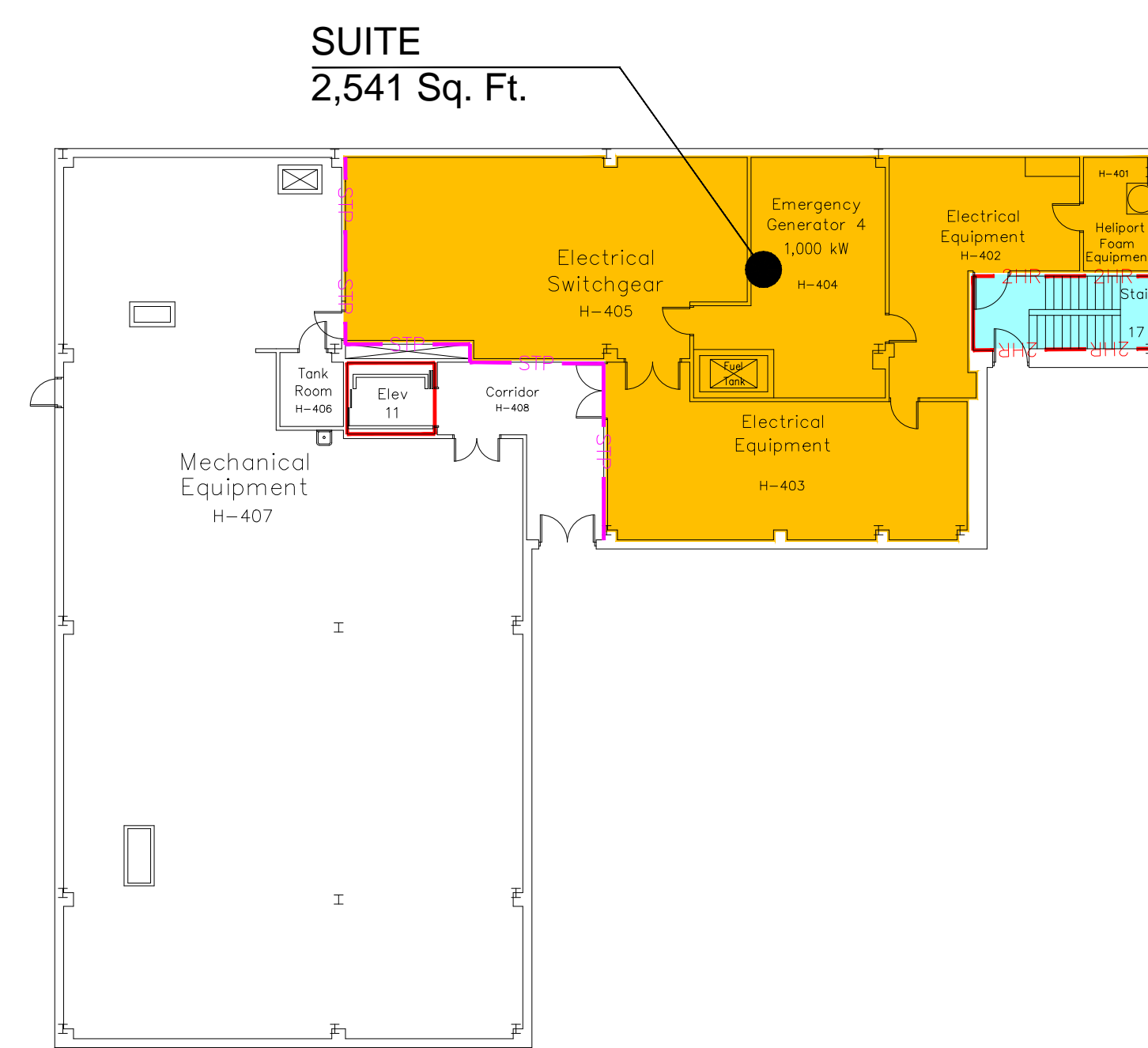
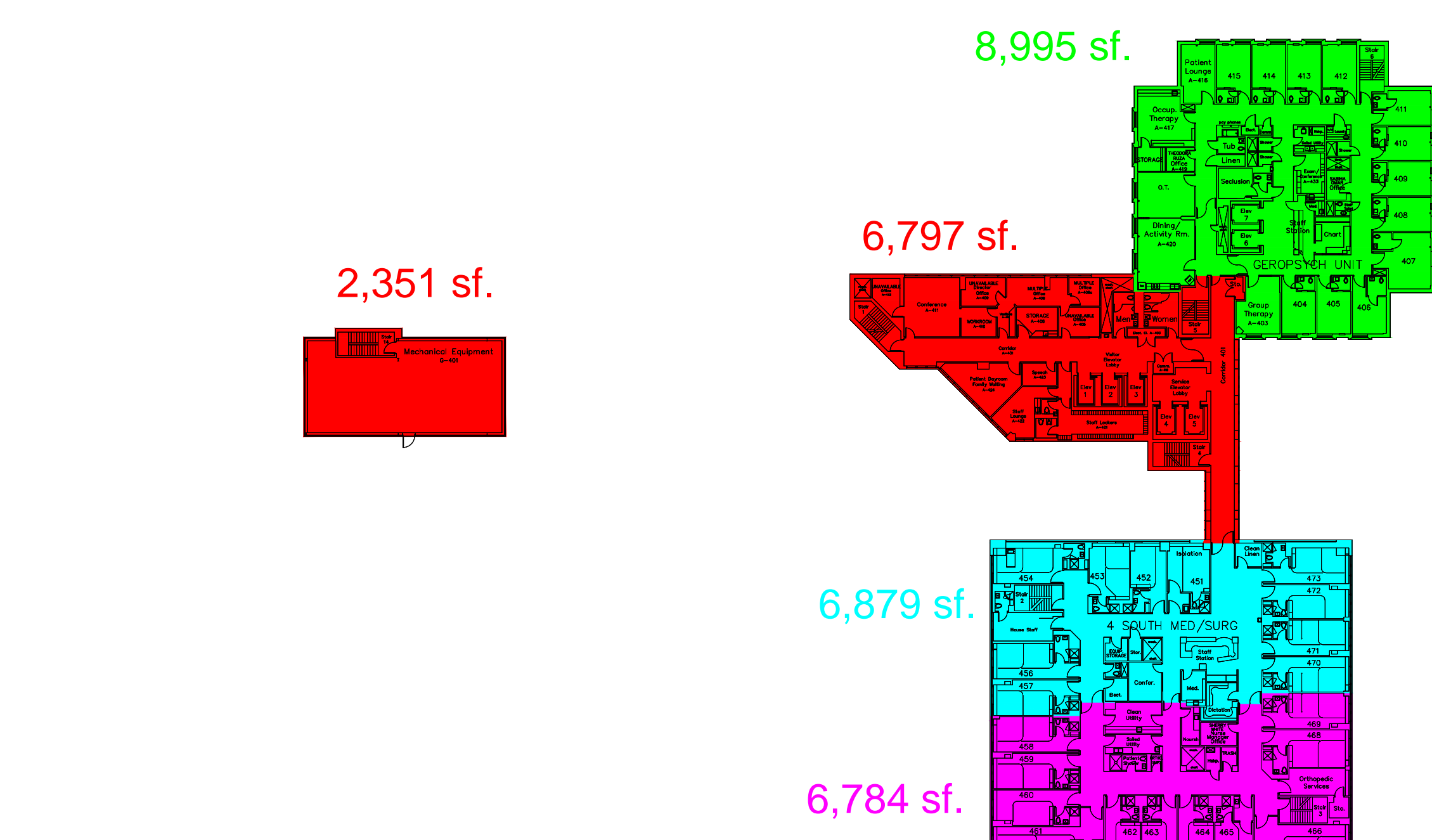
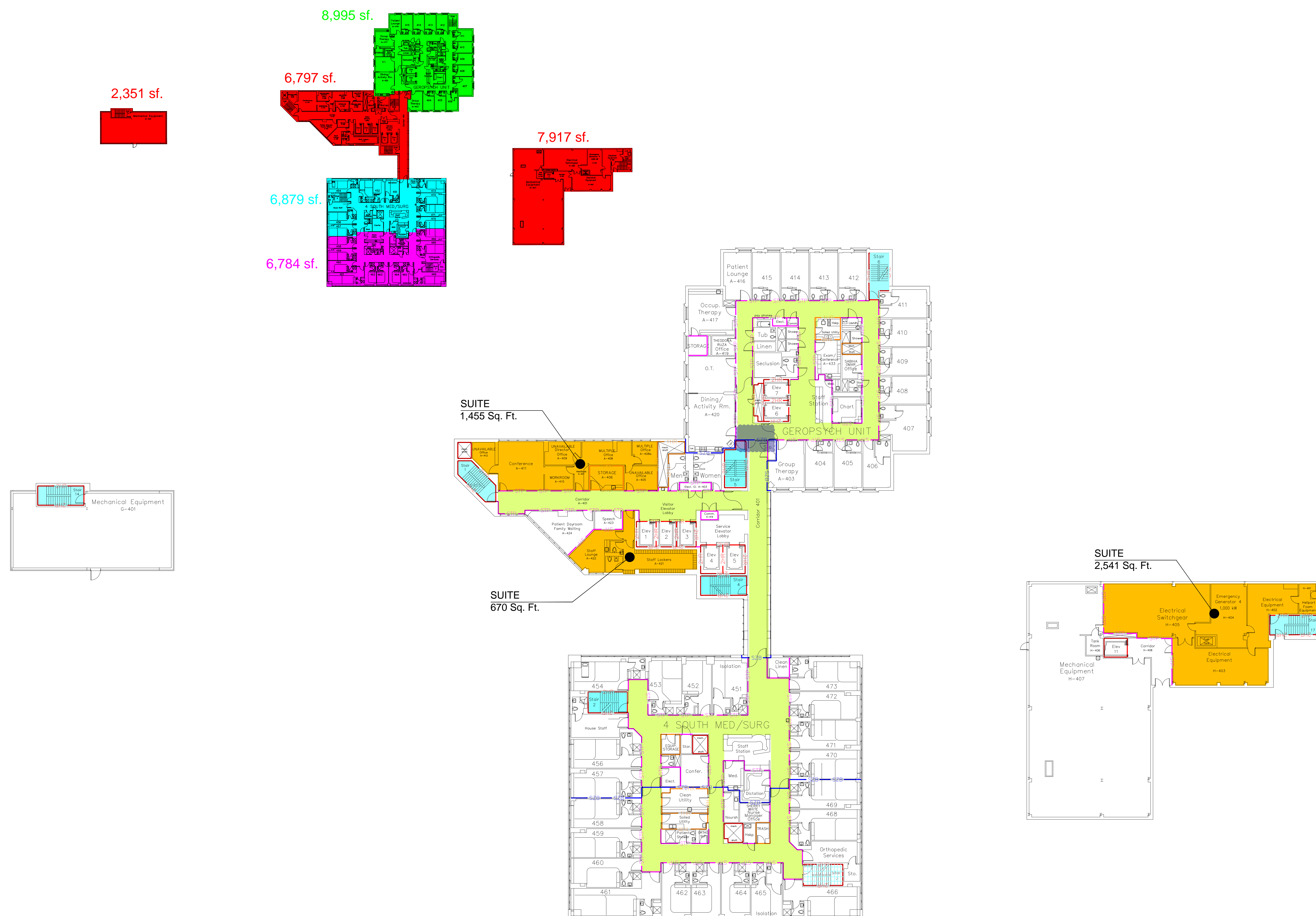

**Note:**  
The Record Conditions Depicted Here Within This Drawing Are Based On Construction As-Built Information and Partial Field Verification. Non-employees Of William Beaumont Using This Document Are Hereby Notified That William Beaumont Hospital Assumes No Liability For The Accuracy Of The Information As Shown. Using This Document In No Way Relieves The User Of Responsibility For Verification Of Actual Field Conditions.

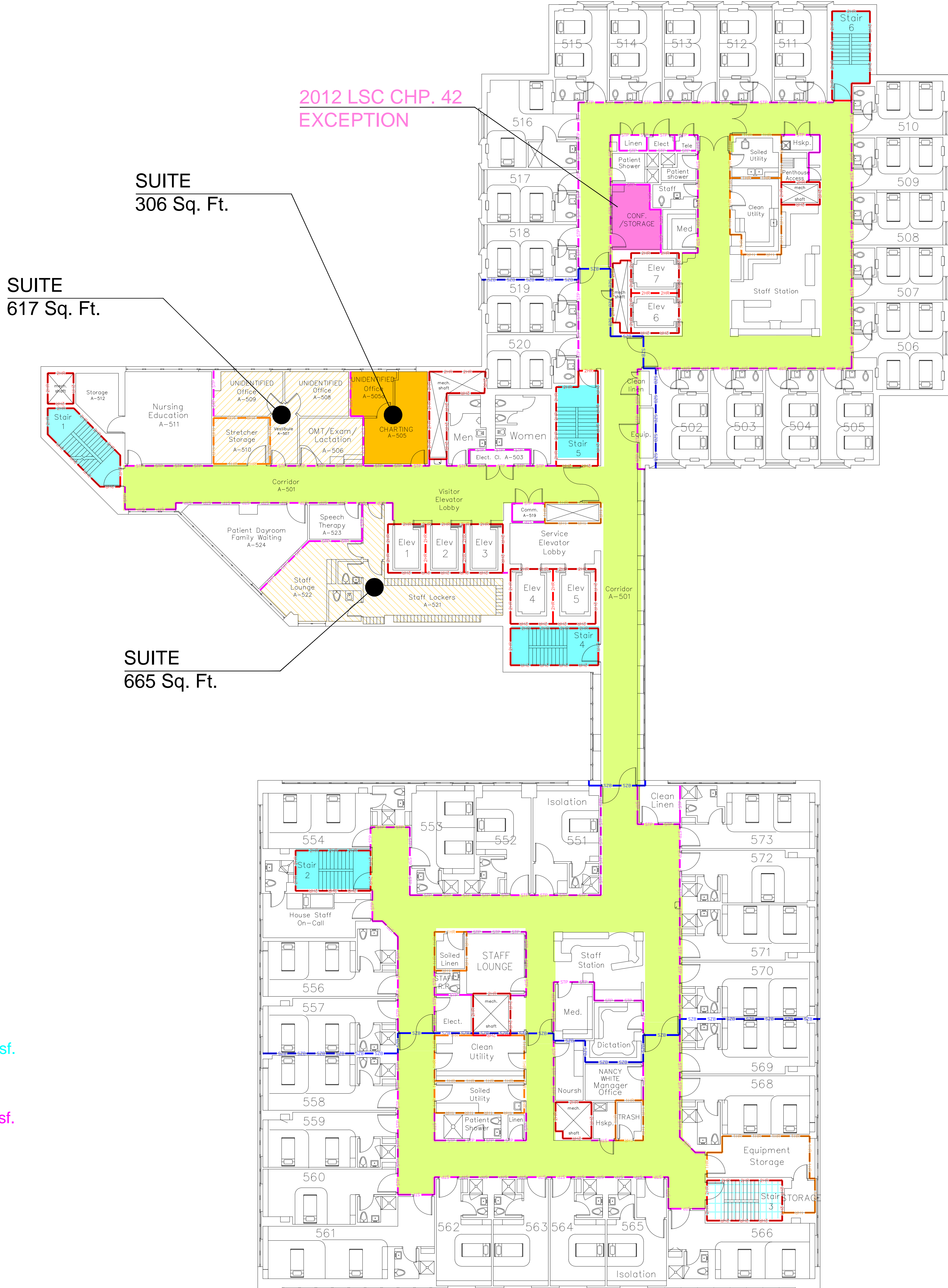

2012 LSC CHP. 42  
EXCEPTION

SUITE  
306 Sq. Ft.

SUITE  
617 Sq. Ft.

SUITE  
665 Sq. Ft.

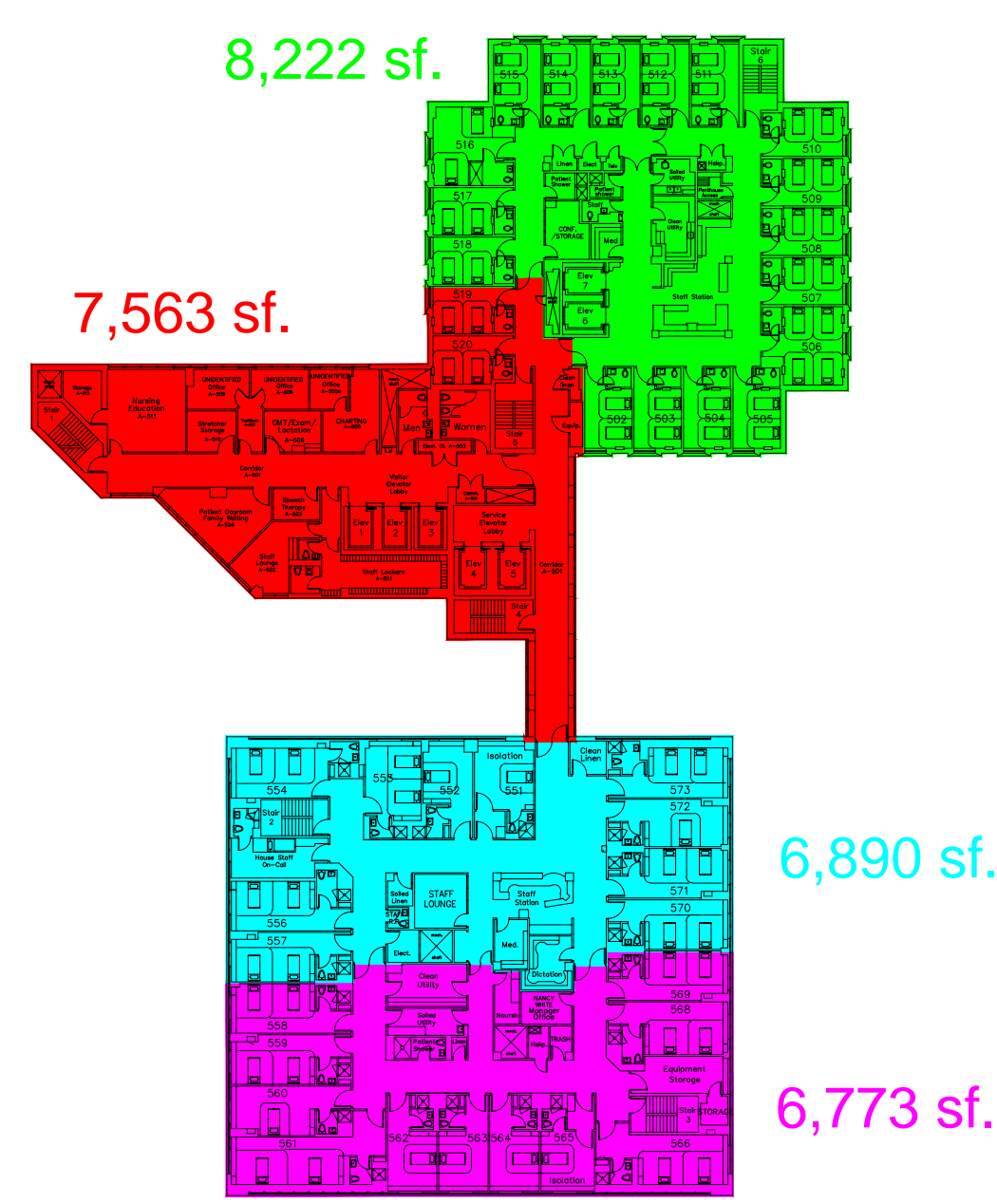

**PARTITION LEGEND**

WALL RATING	NFPA 101 - LIFE SAFETY CODE- 2012 EDITION
	FULLY SPRINKLERED WITH QUICK RESPONSE SPRINKLER HEADS
30 min.	*Corridor construction in existing facilities that are not fully sprinklered. *Walls are to extend to the structure above or a fire rated ceiling assembly. *Doors shall have a 20 minute label, resist the passage of smoke and have positive latching.
MI Building Code- MBC One - Hour (Royal Oak Only)	* Opening Protectives Shall Be Self Closing Or Released Upon Activation Of Fire Alarm. * Positive Latching Doors * Gap At Door Stop Max. 1/8" * Double Doors Require Astragals If Gap Between Doors Is Greater Than 1/8" * Door Undercuts Max. 3/4" * Maximum Measurement For Doors That Are Skewed Or Out Of Plumb Is 1/2" * Michigan Building Code 1HR Fire Dampers Required In Solved Utility Rooms & Rooms without Ceilings * 3/4 Hour Door * All Penetrations Shall Be Sealed With Approved (HLTI) Fire Stopping - Floor To Deck
One - Hour NFPA	* Opening Protectives Shall Be Self Closing Or Released Upon Activation Of Fire Alarm. * Positive Latching Doors * Gap At Door Stop Max. 1/8" * Double Doors Require Astragals If Gap Between Doors Is Greater Than 1/8" * Door Undercuts Max. 3/4" * Maximum Measurement For Doors That Are Skewed Or Out Of Plumb Is 1/2" * No Fire Dampers Required * 3/4 Hour Door * All Penetrations Shall Be Sealed With Approved (HLTI) Fire Stopping - Floor To Deck
Two - Hour	* Opening Protectives Shall Be Self Closing Or Released Upon Activation Of Fire Alarm. * Positive Latching Doors * Gap At Door Stop Max. 1/8" * Double Doors Require Astragals If Gap Between Doors Is Greater Than 1/8" * Door Undercuts Max. 3/4" * Maximum Measurement For Doors That Are Skewed Or Out Of Plumb Is 1/2" * Fire Dampers Required * 1 1/2 Hour Door * All Penetrations Shall Be Sealed With Approved (HLTI) Fire Stopping - Floor To Deck
Two - Hour Building Separation	* Same As 2HR Fire Barrier * Can Be Used As A Horizontal Exit
Three - Hour Four - Hour	* Opening Protectives Shall Be Self Closing Or Released Upon Activation Of Fire Alarm. * Positive Latching Doors * Gap At Door Stop Max. 1/8" * Double Doors Require Astragals If Gap Between Doors Is Greater Than 1/8" * Door Undercuts Max. 3/4" * Maximum Measurement For Doors That Are Skewed Or Out Of Plumb Is 1/2" * Fire Dampers Required * 3 Hour Door * All Penetrations Shall Be Sealed With Approved (HLTI) Fire Stopping - Floor To Deck
Smoke Barrier	* Walls Built to One Hour Construction * Opening Protectives Shall Be Self Closing Or Released Upon Activation Of Fire Alarm. * Positive Latching Doors Not Required Unless in a Corridor Wall or Fire Barrier * Gap At Door Stop Max. 1/8" * Double Doors Require Astragals If Gap Between Doors Is Greater Than 1/8" * Door Undercuts Max. 3/4" * Maximum Measurement For Doors That Are Skewed Or Out Of Plumb Is 1/2" * Smoke Dampers Required (Royal Oak only) * 20 Minute Door or 1 3/4" Thick Solid Core Bonded Wood Door * No Positive Latching Required For Cross Corridor Doors * All Penetrations Shall Be Sealed With Approved (HLTI) Fire Stopping - Floor To Deck * Center Door Mullions are Prohibited
Smoke Tight Partition	* Corridor construction in fully sprinklered smoke compartment in existing facilities that are not fully sprinklered. * Smoke Tight Construction * No Door Labels- Solid Core Door Minimum * Positive Latching Doors * Door Undercuts Max. 1" * Maximum Measurement For Doors That Are Skewed Or Out Of Plumb Is 1/2" * If Ceiling & Doors are Smoke Tight Construction, Walls To Deck Not Required * If There is No Ceiling in Space, Walls to Deck Above are Required * Must Meet The Requirements Of The Most Stringent.
One - Hour Smoke Zone Barrier	* Must Meet The Requirements Of The Most Stringent.
Two - Hour Smoke Zone Barrier	* Must Meet The Requirements Of The Most Stringent.
Variance Areas	* See Variance Granted By Authority Having Jurisdiction.
Change of Use	* Change of use as allowed by 2012 NFPA 101 LSC 43.7.1.2
Egress Corridors	* Minimum Smoke Tight Construction * No Combustible Storage Open To Corridor * No Clear Width Construction Allowed.
Exit Stairwells	* 4 Levels Or Less 1 Hour * 5 Levels Or More 2 Hour * Positive Latching Doors * Opening Protectives Shall Be Self Closing Doors Or Released Upon Activation Of Fire Alarm System
Connecting Stairwell	* No Storage Allowed * Only Utilities That Serve The Stair Can Run In The Stair * No Clear Width Construction Allowed * All Penetrations In Walls & Ceiling To Be Sealed With Approved (HLTI) Fire-stopping * Penetrations In Landings Do Not Need To Be Sealed.
Hatch Pattern Will Vary For Adjacent Suites	* Non-Rated Doors Do Not Require Positive Latching Within Suite * Hallways Within Suite are Not Required to be Smoke Tight * Corridor Entry Doors to Suite Require Positive Latching * Perimeter Suite Walls Abutting Corridors Require Minimum Smoke Tight Partition Construction * Sleeping suites are noted on plans.

ROOM TYPE	REQUIREMENTS
* Storage Of Combustibles Less Than 100 L.T.	* Smoke Tight Construction (See Partition Legend) * Self Closing Doors * Doors Not Serving Corridor Do Not Need To Latch * Fire Sprinkler Protection
* Storage Of Combustibles Greater Than 100 L.T. * Solved Linen Storage	* 1 Hr Construction (See Partition Legend) * Fire Sprinkler Protection
* Medical Gas Storage Greater Than 12-E Cylinder Or 1-H Cylinder Per Smoke Compartment - Does Not Include In Use Cylinders.	* Fire Sprinkler Protection * Doors Must Be Secured Against Unauthorized Entry. * Oxygen And Nitrous Oxide Shall Not Be Stored With Any Flammable Gases, Liquid Or Vapor. * Oxygen Or Nitrous Oxide Must Be Separated From Combustibles By 5 Ft Or Within An Enclosed Cabinet With A Minimum Fire Rating Of 1/2 Hr.
* Rack / Shelf Storage	* Minimum Distance From Sprinkler Head Of 18" With Exception Of Storage Directly Against The Wall.

LAST REVISED: **6/26/2017**

REVISION: **M.J.L.**

SCALE: **NO SCALE**

PROJECT: **FARMINGTON HILLS FIFTH LEVEL COMPOSITE LIFE SAFETY FLOORPLAN**

DWG. NO.: **LSP-05**

SYSTEM DES.: **FH-LIFE SAFETY**